



# Pump Stand

Quick Installation Guide

Pump Stand for Vertical Pressure Tanks



For Installation Video  
**SCAN HERE**

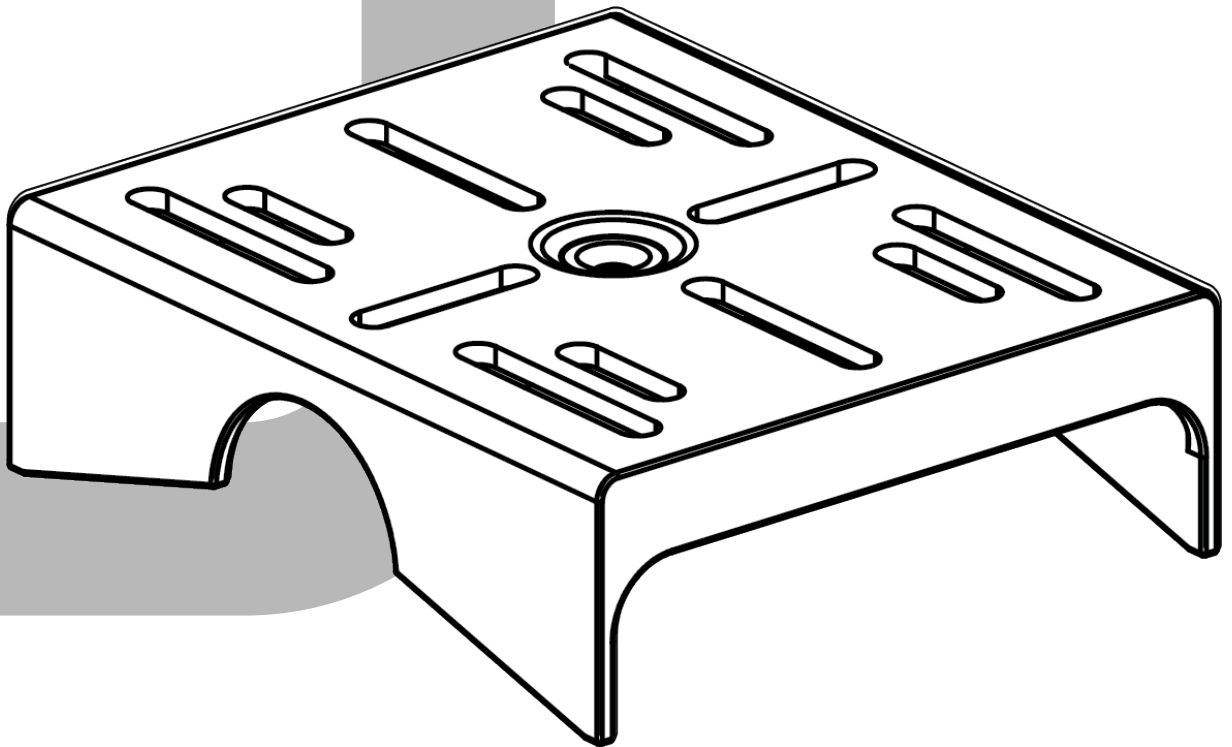



# HOW TO INSTALL PUMP STAND

For Vertical Pressure Tanks

## STEP #1: CHECK ALL YOUR COMPONENTS

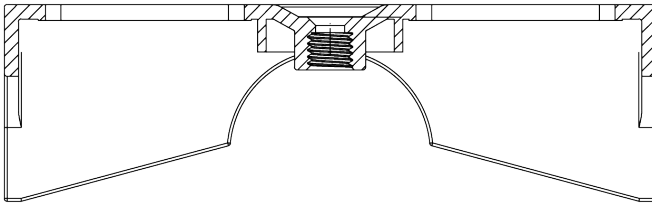

PUMP STAND

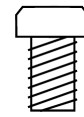

HEIGHT ADAPTER

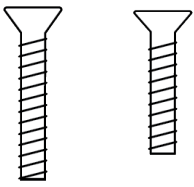

- long screw - 2"
- short screw - 1-1/2"

MOUNTING SCREWS

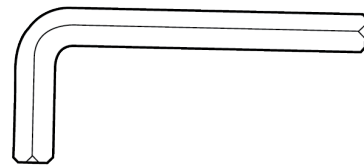

ALLEN WRENCH

## STEP #2: CONNECT HEIGHT ADAPTER TO PUMP STAND

- Screw in height adapter on the underside of the pump stand

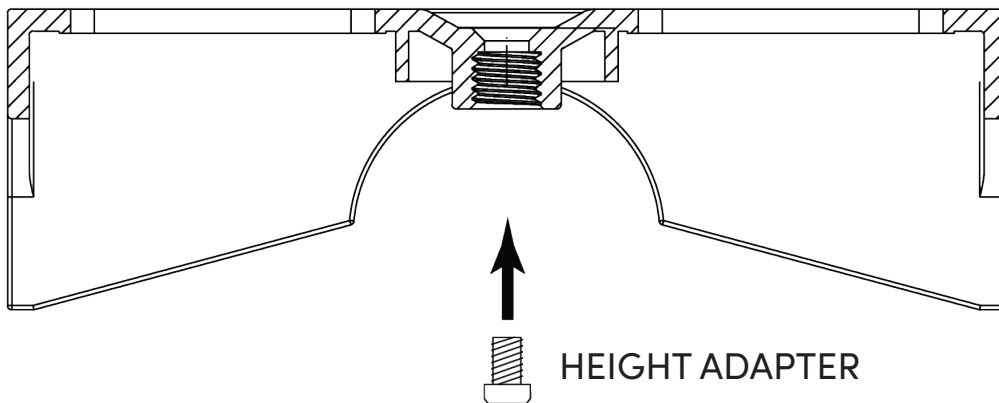

PUMP STAND

HEIGHT ADAPTER

**STEP #3: ADJUST HEIGHT ADAPTER AS NECESSARY**

- Based on your tank surface, adjust the height adapter to the appropriate level. Ensure it is positioned securely.

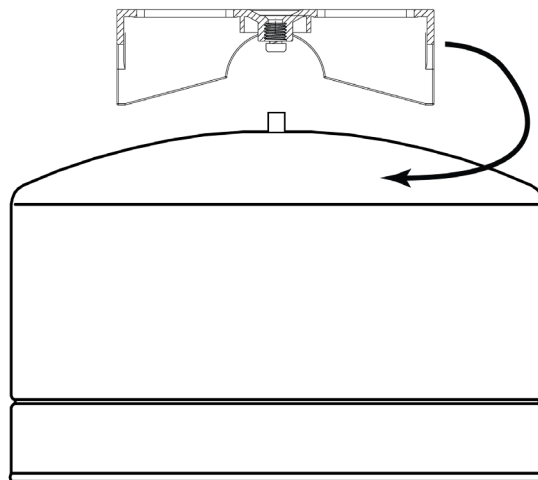

**STEP #4: SECURE THE PUMP STAND WITH MOUNTING SCREW**

- Seat the pump stand evenly on top of the pressure tank.
- Select the appropriate length screw to connect to the vertical tank's top nut.  
For PWN-US-80LV/130LV, 1-1/2" screw  
For PWN-US-160LV, 2" screw
- Secure the pump stand by screwing in the provided mounting screw.
- Tighten the screw using the allen wrench to ensure a stable and secure connection.

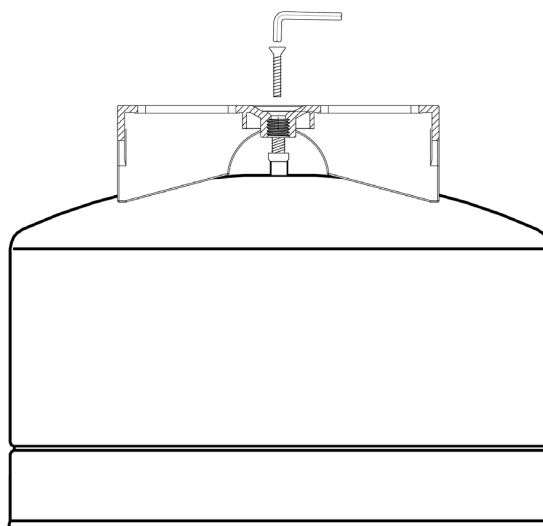



## HOW TO INSTALL PUMP STAND

For Vertical Pressure Tanks

### STEP #5: READY TO USE

- Your pump stand is now correctly installed and ready for use with your vertical pressure tank. Ensure that all connections are tight and secure before installing the pump.
- Now you are ready to place and secure the pump on the pump stand.
- Follow the pump manufacturer's instructions for attaching and securing the pump to the pump stand. Make sure pump is secure to minimize vibration.

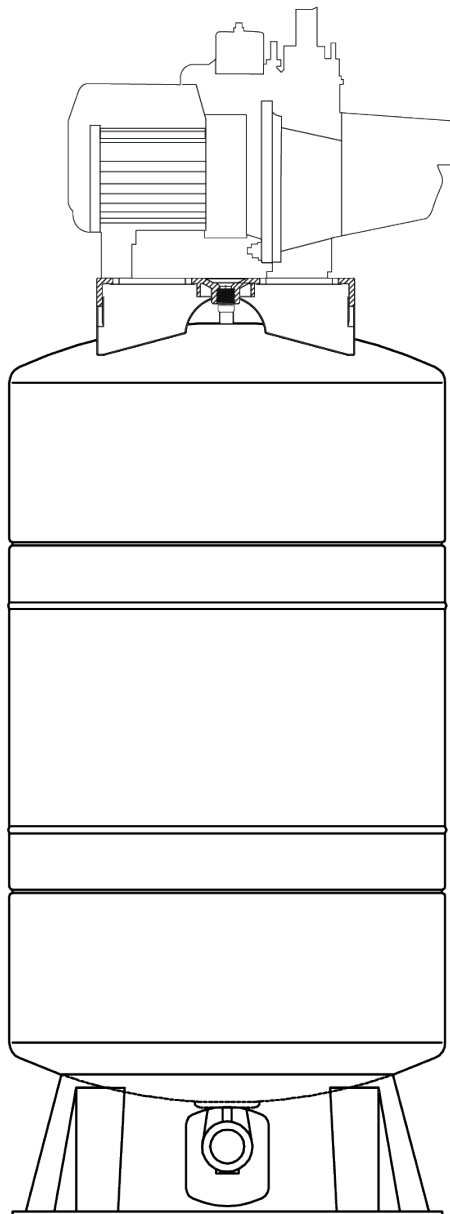



**Have questions or need assistance?**

[www.gwsusa.com](http://www.gwsusa.com)